

OLS-2000 Series

Occupancy Light Switch



OLS-2000

Description

The OLS-2000 Occupancy Light Switch, a passive infrared sensor, is designed to turn lights on when it detects human movement

within its field of view. The sensor is an indoor lighting control and should not be used outdoors, or as a security device, or to control fans, heaters, or air conditioners.

Features

- three settings: time delay, daylight sensor lockout, and sensitivity control, to allow for changes that best match the room's use and the occupants' needs
- standard, single-toggle light switch size allows quick, easy replacement of existing wall switches, reducing installation time
- infrared occupancy sensor can control lighting usage based on occupancy
- a single model provides compatibility with supply voltages in commercial buildings
- low-profile design and decorative wall plate complement building and office decor
- 180° field of view and coverage to 900 square feet covers most offices, conference rooms, and storage areas

- the adjustment cover has an anti-tamper feature that prevents unauthorized changes to selected settings

Applications

- lighting control in enclosed offices, conference rooms, computer rooms, and small common areas in a building
- replaces standard, single-pole, indoor light switches that control incandescent or fluorescent fixtures that use magnetic or electronic ballasts
- use alone or to complement integrated lighting systems

Repair Parts

Replace the unit.

To Order

Specify the code number from the following selection chart.

Selection Chart

Code Number	Description		
	Lighting Type	Voltage	Load Range Maximum
OLS-2100-1	Incandescent	120 VAC, 60 Hz ^(a)	0 to 800 Watts
	Fluorescent	277 VAC, 60 Hz ^(a)	0 to 1200 Watts

(a) The OLS-2000 is not designed to operate at 50 Hz.

Dimensions

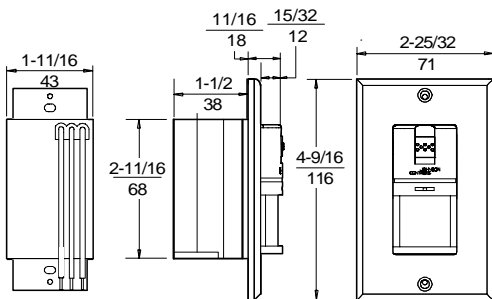

Note:
Wall plate shown here is not included with the OLS-2000-3 (347 VAC Model).

Specifications

OLS-2000 Series Occupancy Lighting Switch	
Sensor Type	Passive infrared
Current Consumption	Less than 0.5 mA
Wiring	3-wire installation
LED Indicator	Flashes when motion is detected
Wall Plate	Included
Temperature Conditions	32 to 95°F (0 to 35°C)
Humidity Conditions	5 to 95% RH noncondensing, 85°F (29°C) maximum dew point
Field of View	180°, 900 sq. ft (81 sq. m)
Daylight Lockout Control	Lights stay off if the ambient light level is adequate
Time Delay Control	30 seconds to 30 minutes
Sensitivity Control	Adjustable from 20 to 100% of maximum sensitivity
Override	Jumper pin converts the OLS-2000 to an on/off switch
Mounting Style	Vertical, with template for standard 2 in. W x 4 in. H x 1-7/8 in. D utility box
Agency Approvals	UL Listed (120 VAC and 277 VAC models), cUL Listed (120 VAC)